

MEDIUM AND HIGH PRESSURE STAINLESS STEEL TUBINGS



Cold draw seamless tubing

From 1380 to 4150 bar (20000 to 60000 psi)

Description

Cold drawn thick wall seamless tubing for fluid or gas high pressures applications such as hydraulic, test equipment, waterjet and water-cutting

Material

Stainless steel TP316/316L Also available upon request in Hastelloy, Duplex, Superduplex, Inconel and Monel

Standard

6 meters (20 feet) Also available in different lengths upon request

External surface finish

Bright finish, free from lumps, flaws and fissures

Inner surface finish

Minimum 100 RMS = 2,3 Ra μm = 92 AARH

Tolerance

OD and ID: $\pm 0,1$ mm WT: $\pm 10\%$

Temperature range

-252°C to +649°C (-421°F to +1200°F)

Inspection Certificate

UNI EN10204:2004 type 3.1



Part Number	OD		ID		WT		WP		Length		Weight
	Inch	mm	Inch	mm	Inch	mm	bar	psi	m	ft	Weight
HT20TU04A000100	1/4"	6.35	0.109"	2.77	0.070"	1.78	1379	20000	6	20	0.202
HT20TU06C000100	3/8"	9.53	0.203"	5.16	0.086"	2.18	1379	20000	6	20	0.397
HT20TU09E000100	9/16"	14.3	0.312"	7.92	0.125"	3.18	1379	20000	6	20	0.874
HT20TU12F000100	3/4"	19.1	0.438"	11.1	0.156"	3.96	1379	20000	6	20	1.484
HT20TU16G000100	1"	25.4	0.562"	14.3	0.219"	5.56	1379	60000	6	20	2.733
HT60TU04B000100	1/4"	6.35	0.083"	2.11	0.083"	2.11	4137	60000	6	20	0.225
HT60TU06E000100	3/8"	9.53	0.125"	3.18	0.125"	3.18	4137	60000	6	20	0.500
HT60TU09D000100	9/16"	14.3	0.187"	4.75	0.187"	4.78	4137	60000	6	20	1.225

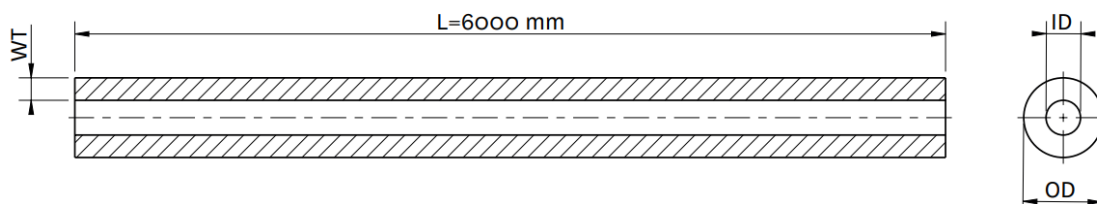

Contacts:

Lavorazioni Tecnologiche srl

Via Po', 1

33054 - Lignano Sabbiadoro (UD) Italy



info@highpressuretechnology.it
www.highpressuretechnology.it
(IT) (+39) 0431-721482